

SECTION 412-01 Climate Control

CONTENTS	PAGE
Temperature Blend Door Actuator — RH	412-01-2

Temperature Blend Door Actuator — RH

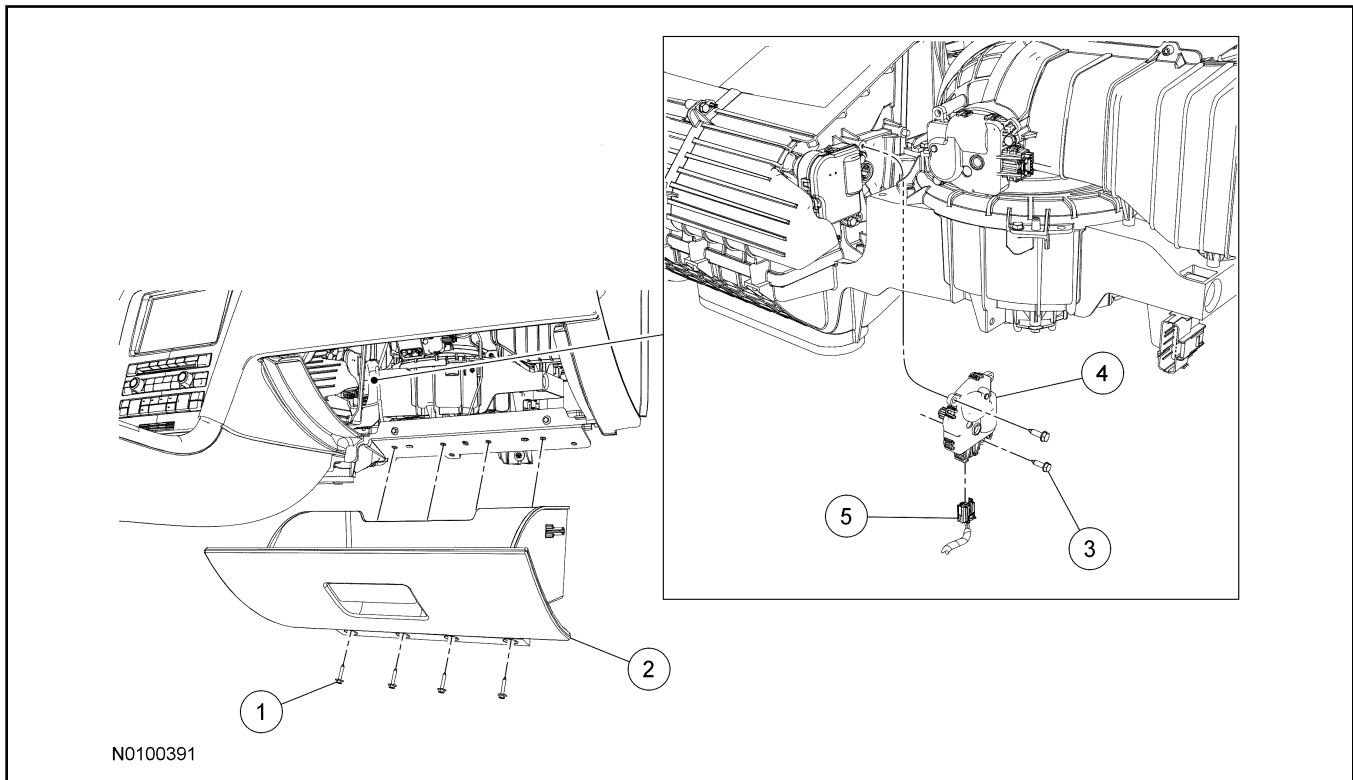

Item	Part Number	Description
1	W505156	Glove compartment screw (4 required)
2	63060T10	Glove compartment
3	W701696	RH temperature blend door actuator screw (2 required)
4	19E616	RH temperature blend door actuator
5	—	RH temperature blend door actuator electrical connector (part of 18B574)

Removal and Installation

- Remove the blower motor. For additional information, refer to Blower Motor in this section.
- Remove the 4 glove compartment screws and remove the glove compartment.
- Remove the 2 RH temperature blend door actuator screws.
- Reposition the RH temperature blend door actuator and disconnect the RH temperature blend door actuator electrical connector.
- Remove the RH temperature blend door actuator.
- To install, reverse the removal procedure.
- NOTE:**
The purpose of the module actuator position calibration is to allow the HVAC module to reinitialize and calibrate the actuator stop points. To carry out calibration, carry out the following steps.

Remove Smart Junction Box (SJB) fuse 15 for at least one minute.
- NOTE:**
When the ignition switch is switched to the ON position, the HVAC module will initialize and calibrate the actuators. Calibration of the actuators will take approximately 30 seconds.

Reinstall SJB fuse 15. Turn the ignition switch to the ON position and wait 30 seconds before verifying correct RH temperature blend door actuator operation.